

Productinformation

Control Box EBF-05



- Frequency controller for conveyors with variable speed
- Motor currents max. 370 or 750 watts
- External switch-off possible
- Speed settings using internal potentiometer
- Integrated EMV - filter
- Aluminium housing
- Voltage 230 V, 50-60 Hz, Protection IP 54



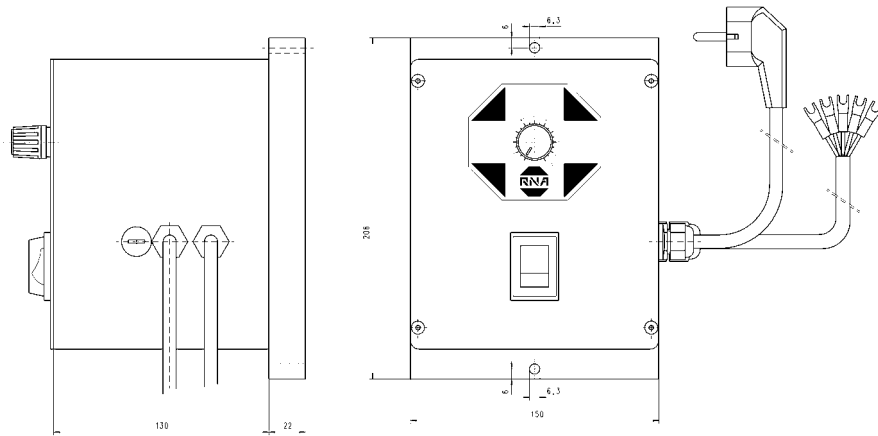

Description

Control boxes of type EBF 05 are microprocessor-controlled units for speed control of RNA-conveyors, elevators and step feeders. Two types are made available for following power ranges 0,37 kW and 0,75 kW.

Out of a single phase mains of 230 V, 50 or 60 Hz the controller generates a three-phase motor with adjustable frequency. Such powered motors are of a asynchron cage motor type and continuous speed control is made available ranging from 17 Hz to 85 Hz. The lower limit consists of the minimum speed required for cooling, the upper limit depends on the maximum admissible speed of the bearing.

The unit has remote start and stop switching facilities and a message output for troubleshooting, guided on a terminalblock. They are available for the user by adding wiring.

Technical Data

Mains voltage	230 V +10% 50/60Hz
Output voltage	3 x 0-210 V AC
Output frequency	0,5 – 120 Hz
Power class 370 Motor rating max. Rated current	370 W 2,1 A
Power class 750 Motor rating max. Rated current	750 W 3,6 A
Desired value	Potentiometer 10k Ω
Release	Contact
Status relay	250 V, 2A contact open by trouble or missing voltage
Adm. Ambient temperature.	0 – 50 °C
Dimensions 370 and 750	150 x 205 x 180 mm
Radio interference suppression	according EMV – directives
Protection	IP54



Rhein-Nadel Automation GmbH

Reichsweg 19-42 • D-52068 Aachen

Telefon 0241 5109-0 • Telefon (Vertrieb) 0241 5109-159 • Fax 0241 5109-219

Email: vertrieb@rna.de • Internet: www.rna.de